

1

2

3

4

5

6

7

8

ITEM NO.	QTY.	PART NUMBER	DESCRIPTION
1	1	VC0094-OA0152	VLV BODY, 3" x 3 1/16 10M H2S *ACT
2	1	HC0226	GREASE FITTING, 3/4" SAFETAP H2S GBH
3	1	VC0013	NAME TAG - VALVE (MSI/DIXIE)
4	1	AA0007A	GEAR OPERATOR ASSY, WMI 12M w/16" HANDWHEEL
5	1	VC0070	PLUG, 3" (HEX)
6	1	VC0041	INSERT SET, 3" H2S
7	1	VC0029-PSL3	ADJUSTING NUT, 3" H2S 15M -PSL3
8	2	VC0005	PLUG SEAL, 2" H2S (BUNA/BRASS)
9	2	OC0002	O-RING, 3" INSERT H2S
10	1	OC0004	O-RING, 3" ADJ NUT H2S
11	1	HC0006	FLAT WASHER, 1/2" STD
12	1	HC0007	FLAT WASHER, 1/2" OVERSIZED
13	1	HC0009	HEX HD, 1/2"-20 x 1.00"

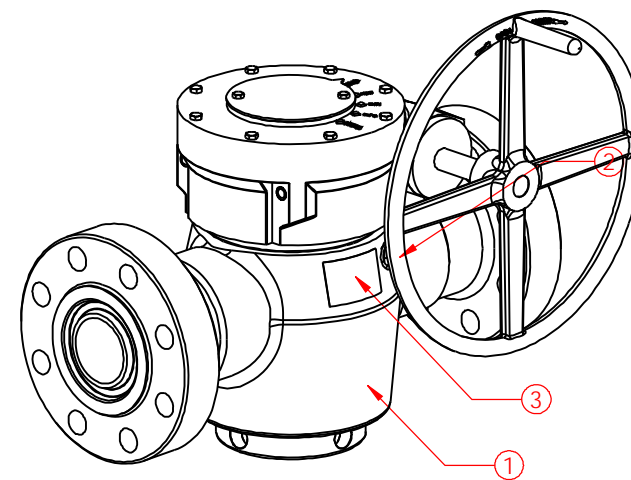
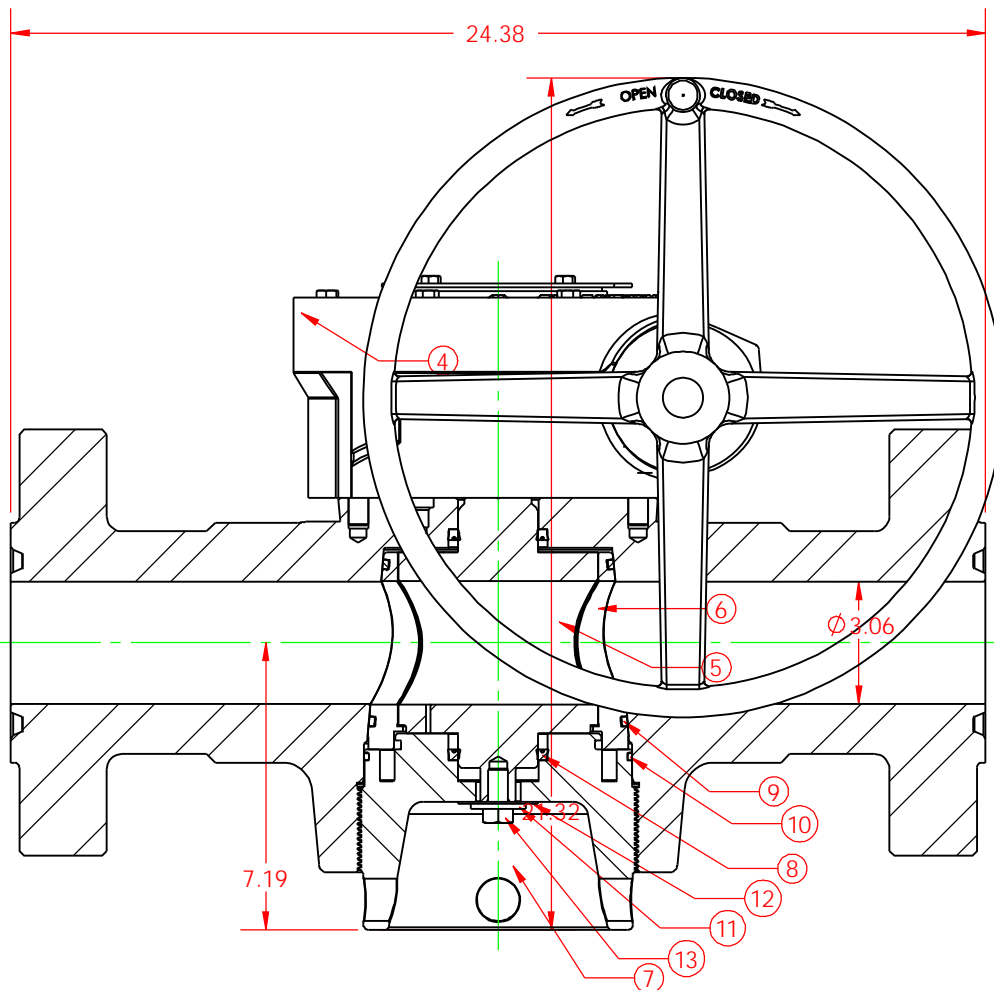

THIS DRAWING IS THE PROPERTY OF DIXIE IRON WORKS, LTD. THE BORROWER AGREES BY RECEIVING THE DRAWING TO RETURN IT UPON REQUEST AND TO NEITHER REPRODUCE COPY OR FURNISH INFORMATION FROM IT TO OTHERS WITHOUT EXPRESSED WRITTEN PERMISSION OF DIXIE IRON WORKS, LTD. ALL ARTICLES MANUFACTURED IN ACCORDANCE WITH THIS DRAWING SHALL BE CONSIDERED DESIGNS OF DIXIE IRON WORKS, LTD. AND MAY NOT BE USED OR SOLD WITHOUT DIXIE IRON WORKS, LTD. WRITTEN PERMISSION.

NOTES

- BREAK ALL EDGES 0.008/0.016 x 45° OR R0.008/0.016 EXCEPT THREADS.
- ALL MACHINED CORNERS R0.031.
- ALL DIMENSIONS ARE IN INCHES (UNLESS OTHERWISE STATED).
- START ALL NICKS, THREADS.
- ALL DIA/EARS TO BE CONCENTRIC WITH GD&S (UNLESS OTHERWISE STATED).
- MACHINED SURFACES TO BE 125µ Ra (UNLESS OTHERWISE STATED).
- ALL DIMENSIONS IN PARENTHESES ARE REFERENCE DIMENSIONS (X.XXX).

THIRD ANGLE PROJECTION



UNSPECIFIED TOLERANCES

FRACTIONS ±1/64
 DECIMALS .XX ±0.015
 .XXX ±0.005
 .XXXX ±0.001

ANGLE ±1/2°

REVISION

0

CHANGE MADE

ECN NUMBER

DESCRIPTION

VALVE,
 3" x 3 1/16 10M H2S (GEAR OP)

MATERIAL/ HEAT TREAT/ WELD PROCEDURE
 SOUR SERVICE
 10,000 PSI WORKING PRESSURE

WEIGHT

SHEET
 SHEET 1 OF 1

DRAWN BY
 WJT

DATE
 07/23/03

PART NUMBER
 VA0108

COMPUTER GENERATED BY



300 West Main Street
 Alice, Texas 78332

REV 0