

ITEM NO.	QTY.	PART NUMBER	DESCRIPTION
1	1	AA0007	GEAR OPERATOR, WMI 12M w/16"HANDWHEEL
2	1	HC0006	FLAT WASHER, 1/2" STD
3	1	HC0007	FLAT WASHER, 1/2" FENDER (2"OD)
4	1	HC0009	HEX HD, 1/2"-20 x 1.00"
5	6	HC0023	LOCK WASHER, 1/2" HIGH COLLAR
6	4	HC0034	SOC HD, 1/2"-13 x 1.50"
7	2	HC0098	HEX NUT, 1/2"-13
8	1	HC0226	GREASE FITTING, 3/4" SAFETAP H2S GBH
9	2	HC0519	HEX HD, 1/2"-13 x 4.50" FULLY THREADED
10	2	OC0025	O-RING, 2.5" INSERT H2S
11	1	OC0026	O-RING, 2.5" ADJ NUT H2S
12	1	UC0014	RESILIENT SEAL, 3"1502 H2S (HNBR)
13	2	VC0005	PLUG SEAL, 1.75" - 3" H2S (HNBR/BRASS)
14	1	VC0020	ADJUSTING NUT, 2.5" H2S
15	1	VC0035S	INSERT SET, 2.5" H2S (SPLIT)
16	1	VC0043	PLUG, 2.5" H2S
17	1	VC0657-OA0185-OA0152	VLV BODY, 2.5"-2 9/16 15M x 3"1502F H2S 10M (GEAR OP)

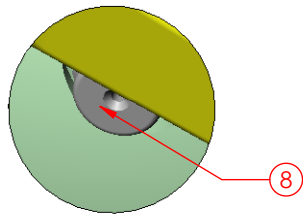

DETAIL B

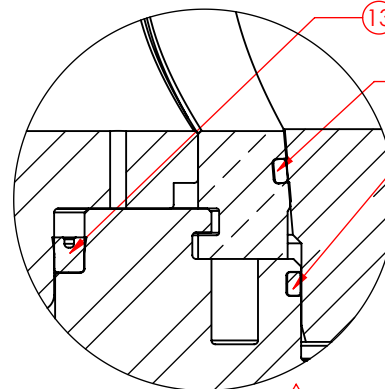
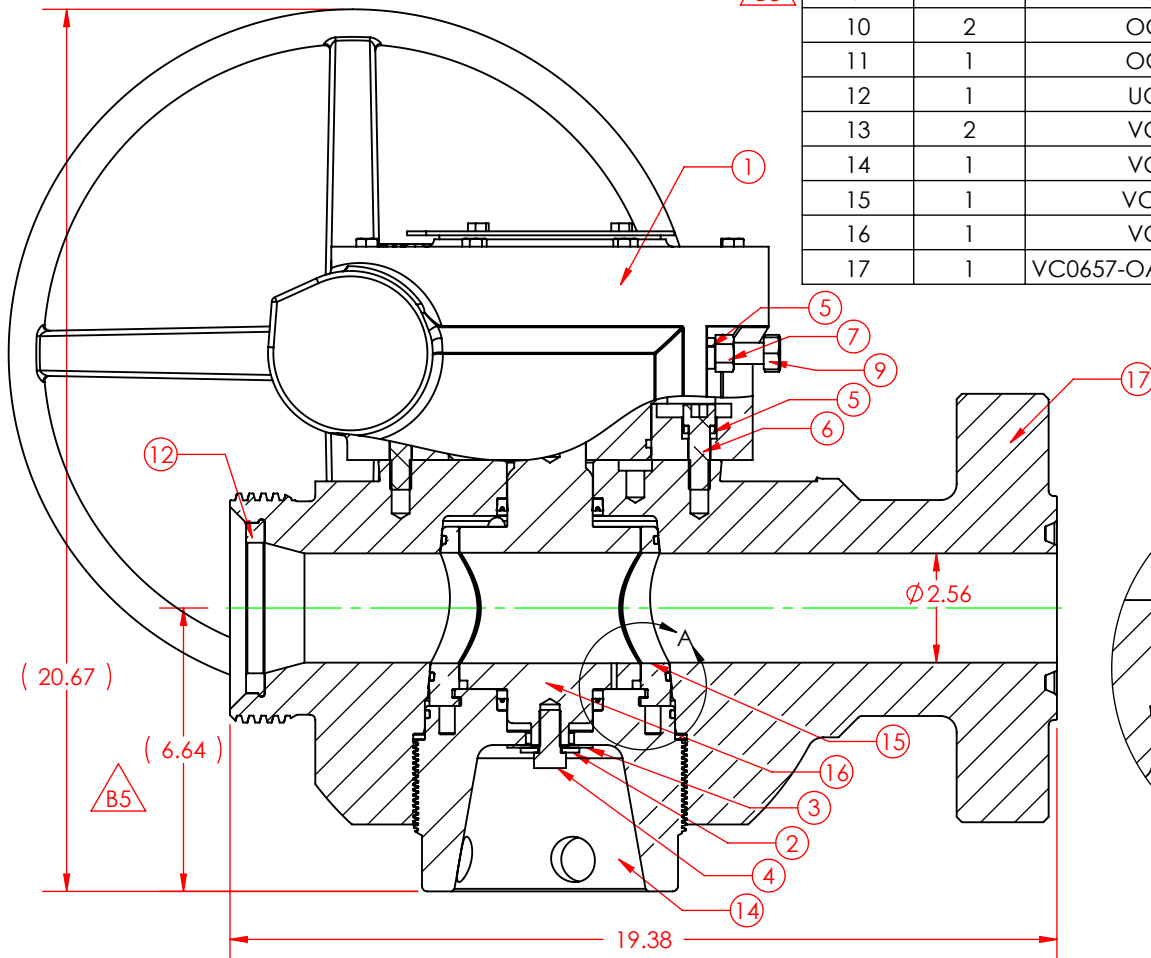

DETAIL A

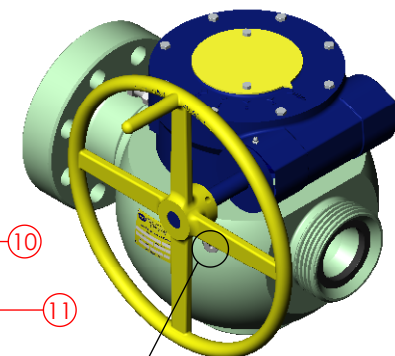

ECH NUMBER 4111	DESCRIPTION VALVE, 2.5"-2 9/16 15M x 3"1502F H2S 10M (GEAR OP)		
	WORKING PRESSURE: 10,000 PSI	TEMPERATURE CLASS: LU	DRAWN BY: HAHII
	RETAINED FLUIDS: EE-0.5	PR LEVEL: 1	DATE: 06/02/06
	WEIGHT 419 lbs.	SHEET SHEET 1 OF 1	PART NUMBER VA0766-S



- CHANGE MADE
- 1) WORKING PRESSURE WAS 15,000; NOW 10,000
 - 2) VALVE WAS FORGING; NOW BAR STOCK
 - 3) REPLACED HC0369; NOW HC0519
 - 4) ADDED DETAIL VIEWS
 - 5) DIM ARE NOW REFERENCE
 - 6) UPDATED DESCRIPTION
- 02/16/11 RSE



THIS DRAWING IS THE PROPERTY OF DIXIE IRON WORKS, LTD. THE BORROWER AGREES BY RECEIVING THE DRAWING TO RETURN IT UPON REQUEST AND TO NEITHER REPRODUCE COPY OR FURNISH INFORMATION FROM IT TO OTHERS WITHOUT EXPRESSED WRITTEN PERMISSION OF DIXIE IRON WORKS, LTD. ALL ARTICLES MANUFACTURED IN ACCORDANCE WITH THIS DRAWING SHALL BE CONSIDERED DESIGNS OF DIXIE IRON WORKS, LTD. AND MAY NOT BE USED OR SOLD WITHOUT DIXIE IRON WORKS, LTD. WRITTEN PERMISSION.

REV: B